

## StormKeeper SK180

The StormKeeper SK180 is the highest quality and structurally sound stormwater chamber available on the market. The StormKeeper family of chambers are designed utilizing the most sophisticated and comprehensive techniques to meet the stringent AASHTO LRFD and ASTM requirements. Intended for use under traffic and nontraffic areas, StormKeeper provides a truly cost-effective and structurally superior system to provide underground stormwater storage, saving valuable land and protecting the environment.



### StormKeeper SK180

#### Nominal Dimensions

Size (L x W x H)	88.7" x 77.8" x 45.5"
Chamber Storage	113.6 cf
Min. Installed Storage	180.0 cf
Weight	127 lbs

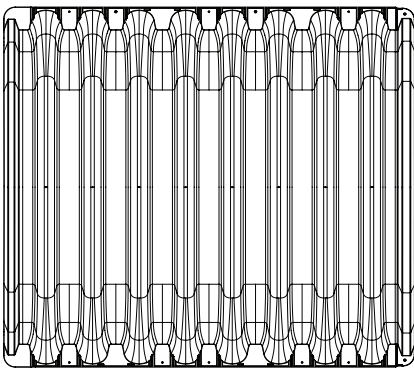

88.7 (2253 mm)

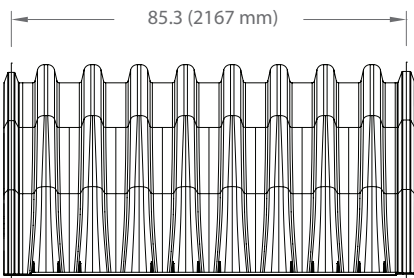

85.3 (2167 mm)

### StormKeeper SK180 End Caps

#### Nominal Dimensions

Size (L x W x H)	32.4" x 76.7" x 44.6"
End Cap Storage	22.4 cf
Min. Installed Storage	60.0 cf
Weight	50 lbs

### Shipping

#### Nominal Dimensions

- 17 chambers per pallet
- 7 end caps per pallet
- 8 pallets per truck

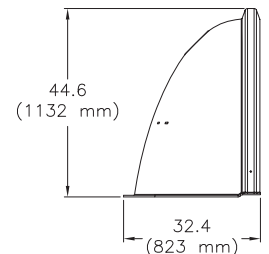
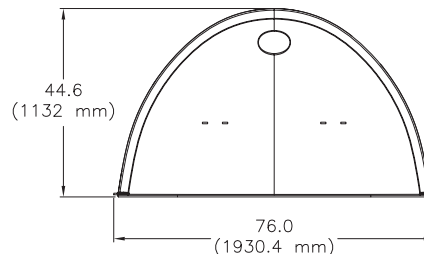
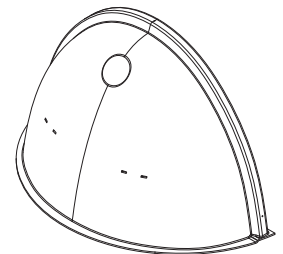
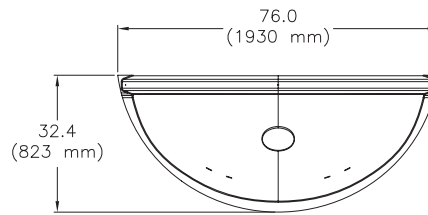

# StormKeeper SK180

## Volume of Excavation Required Per Chamber/End Cap

	Stone Foundation Depth			
	9"	12"	15"	18"
StormKeeper SK180	12.8	13.3	13.7	14.2
StormKeeper SK180 End Cap	5.5	5.7	5.9	6.1

Assumes 8" of separation between chamber rows, 12" of perimeter in front of end caps, and 24" of cover minimum. Should depth of cover exceed 24" the volume of excavation will increase accordingly.

## Storage Volume Per Chamber

	Chamber Volume Only	Chamber and Stone Volume Stone Foundation Depths			
		9"	12"	15"	18"
StormKeeper SK180	113.6 cf	178.9 cf	183.9 cf	188.9 cf	193.9 cf
StormKeeper SK180 End Cap	22.3	54.6	56.8	59.1	61.4

Assumes porosity of 40% in stone plus the chamber and/or end cap volume. End cap volume assumes 6" of perimeter stone.

## Amount of Stone Per Chamber

	Stone Foundation Depth			
	9"	12"	15"	18"
StormKeeper SK180	8.5 tns (6.0 cy)	9.2 tns (6.5 cy)	9.9 tns (7.0 cy)	10.5 tns (7.4 cy)
StormKeeper SK180 End Cap	4.2 tns (3.0 cy)	4.5 tns (3.2 cy)	4.8 tns (3.4 cy)	5.1 tns (3.6 cy)

Assumes 24" of stone above, 8" row spacing, and 12" of perimeter stone in front of the end cap.

